

HYBRID STEPPER MOTOR

TYPE 57HSE76-4204A08-D25

SPECIFICATIONS

diagram

	$1.8^{\circ} \pm 5\%$	current	4.2A
phase No.	2	resistance	$0.5 \pm 10\% \Omega$
insulation resistance	100M Ω m(500V DC)	inductance	$1.8 \pm 20\% \text{mH}$
insulation class	B	holding torque	20kg.cm

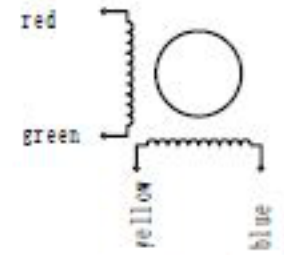

Remarks



GND	white
VCC	red
A+	black
A-	blue
B+	yellow
B-	green

2m/3m



dimensions

unit:mm

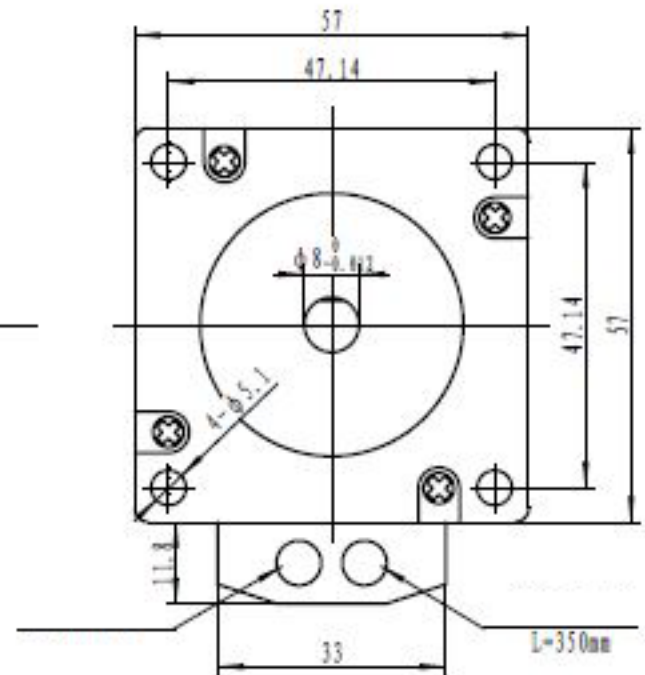
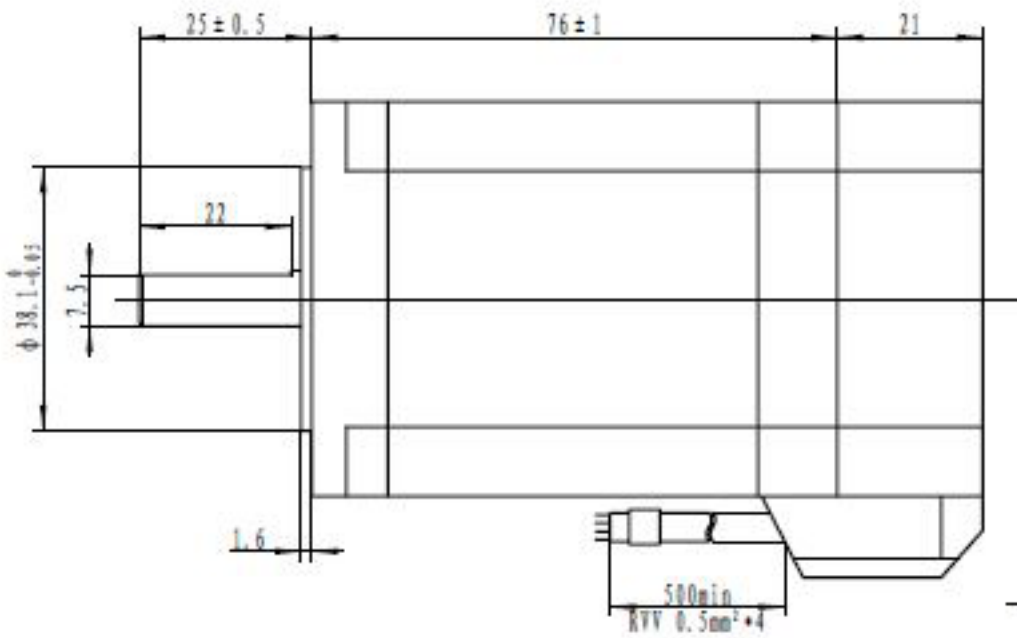

Design	Date	Check	Date	Approve	Date